

## SFP-DE Heated Drip Edge

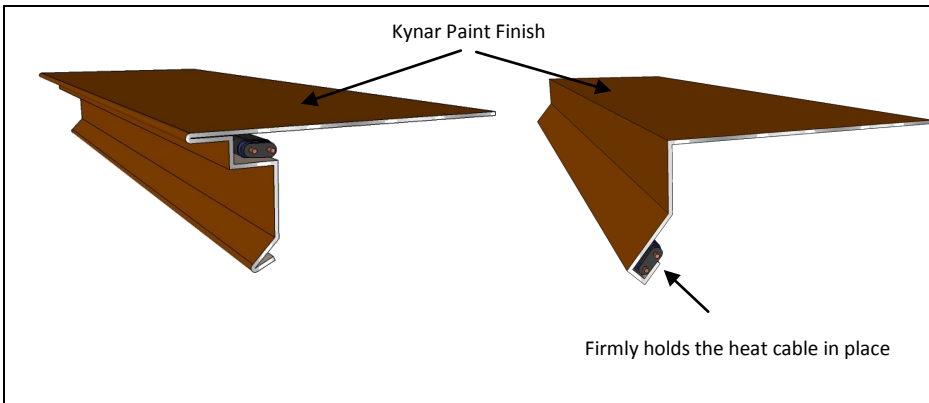

- Works efficiently to reduce icicles on roof edges with no gutters.
- Simple to install
- Attractive and completely hides the wiring along the drip edge.
- Built to match common roofing colors.
- Available in Steel, Aluminum, Copper, Cor10, PVC Clad metal, TPO Clad metal, etc.

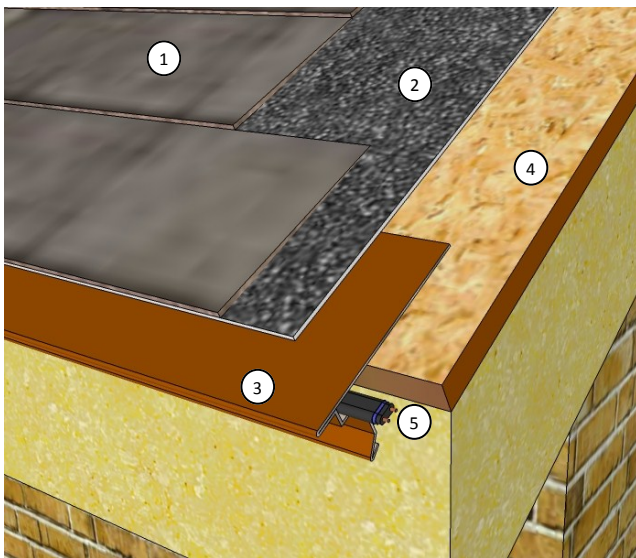

### Key Sections

1. Chosen Roofing Material
2. Ice & Water Barrier
3. SFP-DE-D Style Drip Edge Heater
4. Structural Roof Sheeting
5. Single pass of Self-Regulating 2806 Heater Cable

### Description

The heated drip edge line is to be used when gutters are not available to channel the water away from the building. This is the best product to use when trying to avoid icicles on any type of structure with a metal roof or any type of roof that is designed to shed the snow but can hang up on any ice that could form on the edge. The SFP-DE keeps the aesthetic look of the original roof all while eliminating most icicle issues. All SFP systems come standard with a durable 30-year Kynar finish to match most desired looks.

### Applications

For all buildings with a pitch greater than 1/12

For new roof installations:

- Asphalt Shingle
- Wood Shake Shingles
- Tile or Slate Roofs
- Standing Seam Metal
- PVC, TPO, or EPDM Flat Roofs

For installation on existing roofs:

- Asphalt Shingle
- Wood Shake Shingles
- Tile or Slate Roofs
- Standing Seam Metal
- PVC, TPO, or EPDM Flat Roofs

SFP-DE-D Style

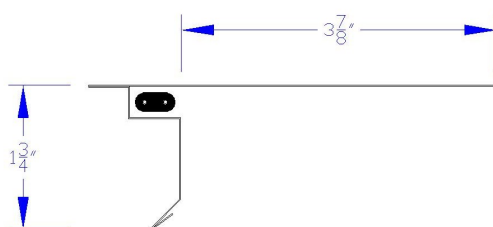

SFP-DE-Standard

