

WARMZONE

PREMIER RADIANT HEATING

SFP-SCH Shingle Cable Holder

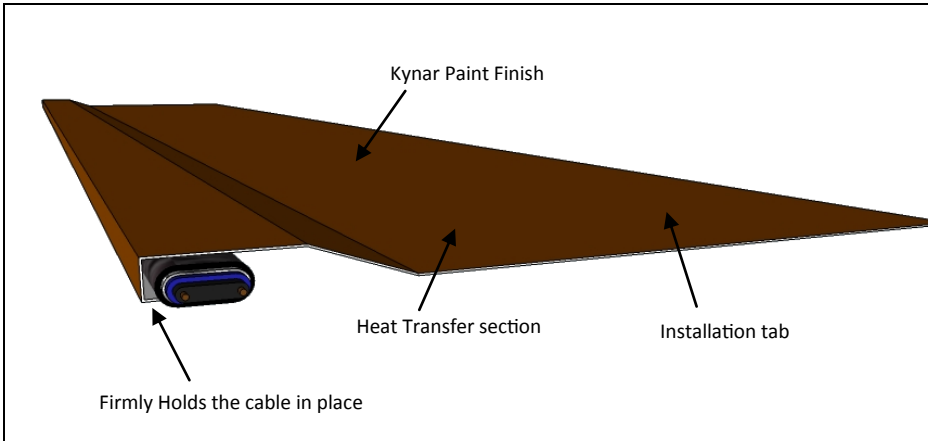

- Beautifully heats the roof while keeping the intended look of the roof.
- Simple to access.
- Attractive and completely hides the heat cable for added protection.
- Simple to Install
- Available in 24 ga. Kynar Steel, Aluminum, Cor10, Copper, Etc.
- Works great for Valleys.

★ For best ice dam prevention, ensure every layer of shingle from the drip edge until 1' above the heated wall is covered. This product should also be used in conjunction with the SFP-Drip Edge systems.

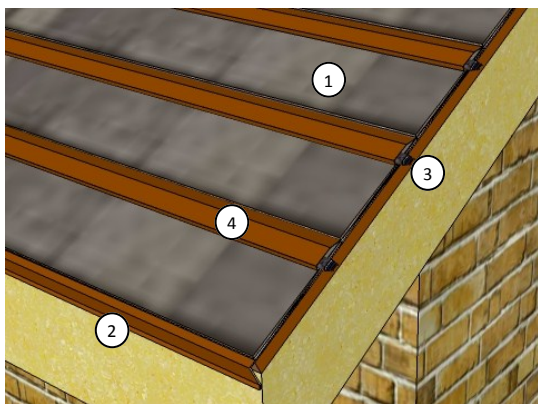

Key Sections

1. Chosen Roofing Material
2. SFP-DE-DStyle Drip Edge Heater or existing drip edge
3. Single pass of Self-Regulating 2806 Heater Cable
4. SFP-SCH Shingle Cable Holder

Description

The Sno-Free SCH Shingle Cable Holder eave system is a low cost method to control any ice dams that would form on a building with asphalt shingles or wood shakes. With close to 7" of each course of shingle covered, the SFP-SCH will create open sections for water to safely flow from the roof without the possibility to refreeze over unheated portions of the roof. The shingle cable holder system gives an aesthetic look compared to standard serpentine heat cable to any structure while keeping a cleaner method to eliminate ice dam issues. All SFP systems come standard with a durable 30 year Kynar finish to match most desired looks.

Applications

For all buildings with a pitch greater than 4/12

For new roof installations:

Asphalt Shingle
Wood Shake Shingles
Tile or Slate Roofs
Standing Seam Metal

For installation on existing roofs:

Asphalt Shingle
Wood Shake Shingles

