

An Insulation Solution insultarp®

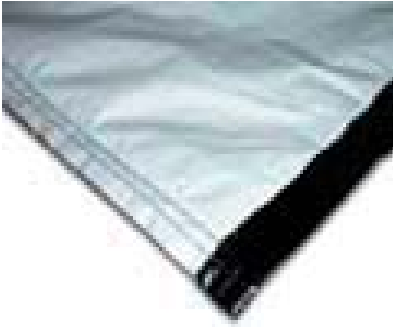

Tools Needed:

- Sharp Utility Knife
- Scissors
- Measuring Tape
- Tape



Installation Instructions

Insul-Tarp® has been designed to be installed quickly and easily by following a few easy steps.

- 1) White Side Up.
- 2) **Insul-Tarp®** comes to the customer in roll form. Simply cut the retaining tape with a utility knife or scissors and unfold the tarp.
- 3) Adjust the tarp to where it is square and install the next tarp. The tarps should be overlapped at the seams. Make sure that you have insulation to insulation. For a continuous vapor barrier, seams should be taped using an appropriate tape product.
- 4) When coming to an obstruction such as plumbing, simply put the tarp up to the obstruction, with scissors or a sharp utility knife, cut an “X” in the tarp. Slide the tarp over the obstruction and continue. When cutting the tarp to size, use scissors.
- 5) **Insul-Tarp®** is manufactured with grommets in the side flanges. These grommets can be used to tie down the tarps in windy conditions.
- 6) If air pockets occur, when pouring the concrete slab, simply cut a slit in the top layer of the tarp to release any trapped air. Then place a piece of appropriate tape over the slit and continue pouring.

Helpful Hints

- When cutting the tarps always use scissors, and install the cut edge under the factory edge. If factory edge is not available, simply tape the edge of the tarp.
- When installing the **Insul-Tarp®** on a sunny day, make sure to wear a pair of sunglasses as the **Insul-Tarp®** will reflect the sun’s rays.
- When ordering square footage for a project, add 6% for overlap and seamed edges. **Insul-Tarp®** is designed with a 2” vapor seam around the tarp. This overlap provides for an effective vapor/moisture barrier. Note: Actual size of tarp may slightly vary in length and width.

Insulation Solutions

An Affiliate of Meyer Enterprises

401 Truck Haven Road
East Peoria, Illinois 61611

Toll Free 866.698.6562
Phone 309.698.0062
Fax 309.698.0065

www.insulationsolutions.com



Floating Slab on Grade w/Exterior Perimeter Insulation

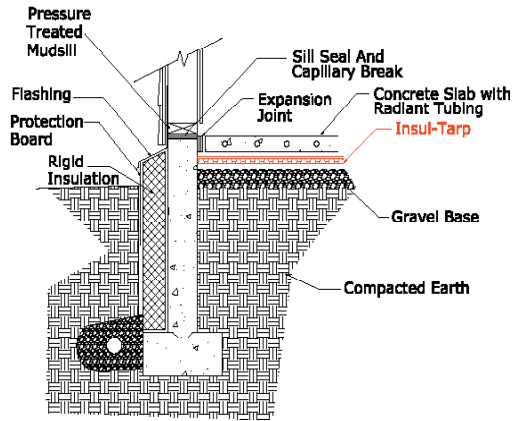

Monolithic Slab On Grade Insulation Details

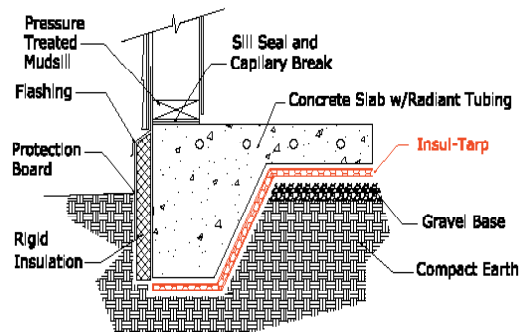

Thermal Break Between Slabs of Heated and Unheated Floor Spaces

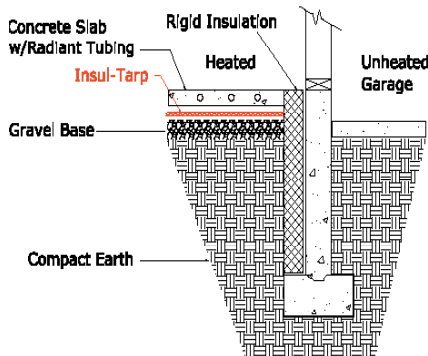

Thermal Break Between Slabs of Heated and Unheated Floor Space

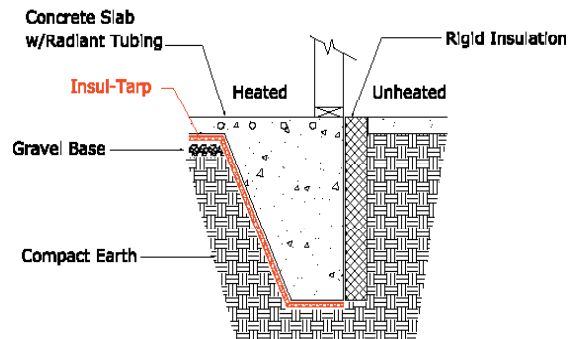

Thermal Break Between Slabs of Heated and Unheated Floor Space

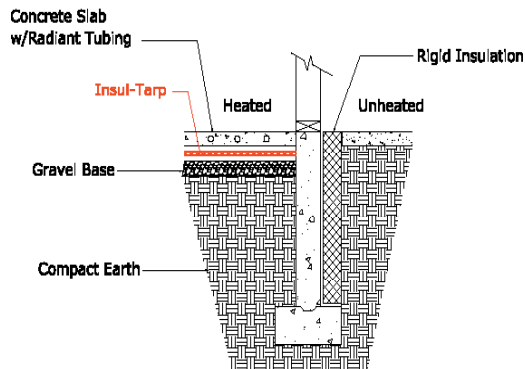

Thermal Break Between Heated Space Slabs And Unheated Crawl Space

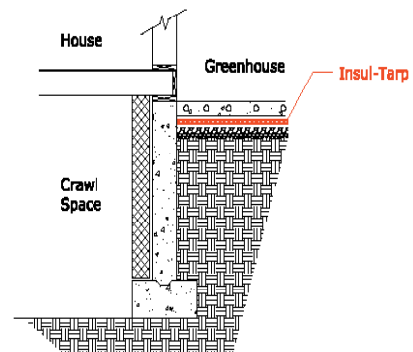

Note: Check with local building codes if you are not familiar with code requirements.